



German Aid Index Number. 18.99.02.1020



Light wheelchair for children and adolescents with mechanical seat tilting from -5° to +35° in the physiological turning point, optional in 2 frame forms (Retro and Taurus) and 2 differently strong V-formed abductions, back adjustable in angle of 78°-126° and folds down to the front, firm wheel base, back height grows + 5 cm (optional: seat width + 2 cm, seat depth + 3 cm), stabilising rod, low friction wheels, cable brake built in to the side guard, nominal load max. 50kg.

Quotation

Order

| User/ID number | Delivery address/company stamp | Billing address |
|-------------------------------------|--------------------------------|---|
| (Please fill in with block letters) | | <input type="checkbox"/> same as delivery address |
| First and surname | Contact person | |
| Health insurance company | Date and signature | |

| Frame versions | | | | Retro frame | Taurus frame |
|--|--|--|--|-------------|--------------|
| Retro frame N°597301 | | Taurus frame N°597304 | | | |
| <input type="checkbox"/> Strong abduction LLL 15-34 cm | <input type="checkbox"/> Slight abduction LLL 15-31 cm | <input type="checkbox"/> Strong abduction LLL 15-34 cm | <input type="checkbox"/> Slight abduction LLL 15-31 cm | | |
| casters on one line with rear wheels | casters narrower than rear wheels | casters on one line with rear wheels | casters narrower than rear wheels | | |

| Frame- and user measures | | | cf. example on p.6 |
|--|---|---|--|
| Seat width in cm (10..) | Seat depth in cm (11..) | Back height in cm (12..) | |
| <input type="checkbox"/> 20 <input type="checkbox"/> 22 <input type="checkbox"/> 24 <input type="checkbox"/> 26 <input type="checkbox"/> 28 <input type="checkbox"/> 30 <input type="checkbox"/> 32 <input type="checkbox"/> 34 | <input type="checkbox"/> 18 <input type="checkbox"/> 20 <input type="checkbox"/> 22 <input type="checkbox"/> 24 <input type="checkbox"/> 26 <input type="checkbox"/> 28 <input type="checkbox"/> 30 <input type="checkbox"/> 32 <input type="checkbox"/> 34 <input type="checkbox"/> 36 | <input type="checkbox"/> 25 <input type="checkbox"/> 30 <input type="checkbox"/> 35 <input type="checkbox"/> 40 <input type="checkbox"/> 45 | |
| we measure: inner distance side guard to side guard | we measure: front edge seat to front edge back rod | (Back height growable by +5 cm each) we measure: top edge seat board to top edge back rod Not selectable when Tarta back system is selected | 1. Real lower leg length of the user (LLL): _____ cm 2. Cushion thickness (CT) _____ cm |

| Colours | | |
|---|--|---|
| Finish alternatives | Moderate metallic effect (except for black and Ultramarine) | Special colours (without additional charge, except for Nightblue) |
| <input type="checkbox"/> Shiny <input type="checkbox"/> Matt Not possible with special colours! N° 1561 | <input type="checkbox"/> Zinc Yellow (02) <input type="checkbox"/> Dark Green (15) <input type="checkbox"/> Pure Orange (21) <input type="checkbox"/> Crimson (04) <input type="checkbox"/> Pastel Blue (20) <input type="checkbox"/> Dark Blue (16) <input type="checkbox"/> Brilliant Blue (08) <input type="checkbox"/> Cream White (17) not metallic: <input type="checkbox"/> Girly Pink (19) <input type="checkbox"/> Black (31) <input type="checkbox"/> Chrome Yellow (06) <input type="checkbox"/> Ultramarine Blue (37) | Strong metallic effect: <input type="checkbox"/> Silver Metallic (36) <input type="checkbox"/> Apple Green Dormant (18) <input type="checkbox"/> Anthracite Metallic (22) <input type="checkbox"/> Fire Red Dormant (45) <input type="checkbox"/> Violet Dormant (50) Coarse structured surface: Dormant col. with additional charge: <input type="checkbox"/> Coarse Black (27) <input type="checkbox"/> Nightblue Dorm. (47) |

| Design package color anodization (Colour examples for anodized colours can be found on our website in the area equipment) | | |
|---|--|---|
| <input type="checkbox"/> anodized Blue (01) <input type="checkbox"/> anodized Red (02) <input type="checkbox"/> anodized Green (03) <input type="checkbox"/> anodized Gold Orange (04) <input type="checkbox"/> anodized Violet (05) N° 1570.. | The following parts are anodized: Caster forks, supporting plate for side guards, hand rims The design package ist only possible in the listed setting. | Restrictions: The hand rims are only available in the design package anodized colours by choosing aluminum hand rims. (not possible with stainless steel, Maxgrepp, PVC, double or nob hand rims) |

| Frame options | | | |
|---|--|--|---|
| Adaption set | Wheel base extension | Anti-tipper | Step tube |
| <input type="checkbox"/> Modification set for growable seat width + 2 cm and seat depth up to 3 cm N° 597799 | <input type="checkbox"/> by 7,5 cm to the back, and adjustment of axis, side guards and brake Attention: Return to standard configuration only possible by new side guards! N° 760177 | <input checked="" type="checkbox"/> left and right, swing away installation adjustable in height | <input type="checkbox"/> Step tube N° 7408 |

| Curved back plate | | | Back extension | |
|---|--|---|---------------------------|--------------------------------------|
| Model 1 | Model 2 | Model 3 | Extended | Retracted |
| | | | | |
| Straight upper edge, 2 cm higher than back height | Straight upper edge, 10 cm higher than back height | Curved upper edge, 5, 10 or 15 cm higher than back height | Back extended (back view) | Retracted back extension (back view) |

| Back | |
|--|----------------------------|
| Tarta® - Back system | Fitting set for solid back |
| <p>Tarta® is an ergonomic back rest that offers best solutions in terms of adaptability. With the SORG adaptation holder you can adapt a Tarta® back rest easily. Not suitable for transport in a vehicle.</p> <p>Order information at www.tartadesign.it/en/distributor/</p> | |

| Seat and back cushions | | | | |
|------------------------|------------------------|-------------------------|-------------------------|-----------------------|
| Standard cushion | Anatomical cushion | Cushion without cover | Breathable cover black | Breathable cover red |
| | | | | |
| Breathable cover grey | Breathable cover green | Breathable cover yellow | Breathable cover orange | Breathable cover blue |
| | | | | |

You can find the colours under www.sorgrollstuhltechnik.de.

| Seat system | | Back system | | |
|--|--|--|--|---|
| Alu seat plate | | Back angle | | |
| <input checked="" type="checkbox"/> screwed on, in the physiological turning point tiltable from -5° to +35° | | <input checked="" type="checkbox"/> Adjustable in angle by raster from 81°, 90°, 102°, 114° oder 126°, folds down forward, incl. stabilising rod | | |
| Blocking set | | Model 1 | Model 2 | Model 3 |
| Mounting set to limit tilting: towards the front to max.: <input type="checkbox"/> 0° tilting towards the back to max.: <input type="checkbox"/> +30°, <input type="checkbox"/> +25°, <input type="checkbox"/> +20°, <input type="checkbox"/> +15° tilting | | BH+2 cm; curve depth: <input type="checkbox"/> 15 mm (...015) <input type="checkbox"/> 30 mm (...030) <input type="checkbox"/> 50 mm (...050) Attention: curve depth 50mm only from seat width 30cm | BH+10 cm; curve depth: <input type="checkbox"/> 15 mm (...115) <input type="checkbox"/> 30 mm (...130) <input type="checkbox"/> 50 mm (...150) BH+20 cm; curve depth: <input type="checkbox"/> 15 mm (...215) <input type="checkbox"/> 30 mm (...230) <input type="checkbox"/> 50 mm (...250) Attention: curve depth 50mm only from seat width 30cm | BH+5 cm; curve depth: <input type="checkbox"/> 15 mm (...315) <input type="checkbox"/> 30 mm (...330) <input type="checkbox"/> 50 mm (...350) BH+10cm; curve depth: <input type="checkbox"/> 15 mm (...415) <input type="checkbox"/> 30 mm (...430) <input type="checkbox"/> 50 mm (...450) BH+15 cm; curve depth: <input type="checkbox"/> 15 mm (...515) <input type="checkbox"/> 30 mm (...530) <input type="checkbox"/> 50 mm (...550) Attention: curve depth 50mm only from seat width 30cm |
| N° 192810 | | N° 693.. | N° 693... | N° 693... |

| Back extension | | Back cover | Tarta® back system | Fitting set | |
|---|--|--|---|---|---|
| for curved back | | Restrictions | Adjustable | Adaptation | |
| <input type="checkbox"/> extension up to 17.5 cm, retractable, with detachable head cushion from SW 22 cm, weight reduction of approx. 1000g compared to a head rest, not possible with head rest (N° 6860..) | | -Model 1: from BH 35 cm -Model 3: from BH 30 cm only with version BH+5 cm -Fitting set N° 692598: from SW 30 cm | incl. back cushion (thickness 2 cm) Breathable Betex cover <input type="checkbox"/> black (20) <input type="checkbox"/> blue (21) <input type="checkbox"/> red (22) <input type="checkbox"/> grey (23) <input type="checkbox"/> green (24) <input type="checkbox"/> yellow (25) <input type="checkbox"/> orange (27) | <input type="checkbox"/> Adaptation holder for Tarta back system incl. Tarta back tubes Mounting possible from SW26 Order information for Tarta back system and instructions at www.tartadesign.it/en/distributor/  | for solid back <input type="checkbox"/> one set of clamps, required for mounting a solid back that is manufactured by the specialist trade Curve depth 50mm only from seat width 30cm |
| N° 686077 | | | N° 611705 | N° 692598 | |

| Seat cushions (All covers with zippers and changeable) | | | | |
|---|---|--|--|--|
| | Standard cushion | Anatomical cushion | Cover design | Incontinence cover |
| <input type="checkbox"/> No seat cushion (please tick if no cushion is required) | Synthetic foam for firm and comfortable seating <input type="checkbox"/> 3 cm (...03) <input type="checkbox"/> 5 cm (...05) | <input type="checkbox"/> Anatomically formed, slight abduction, changeable cover, thickness of cushion measured at slightest point: front 5 cm, back 3 cm. Customized product | Breathable cover <input type="checkbox"/> black (20) <input type="checkbox"/> blue (21) <input type="checkbox"/> red (22) <input type="checkbox"/> grey (23) <input type="checkbox"/> green (24) <input type="checkbox"/> yellow (25) <input type="checkbox"/> orange (27) | <input type="checkbox"/> For standard cushion as chosen on the left |
| | N° 80.. | N° 891002 | N° 80.. | N° 86.. |
| Additional covers for cushions as chosen on the right <input type="checkbox"/> 1 cover (...01) <input type="checkbox"/> 2 covers (...02) | Pressure relief cushion for medium-soft seating <input type="checkbox"/> 3 cm (...03) <input type="checkbox"/> 5 cm (...05) | <input type="checkbox"/> Additional cover for anatomical cushion as configured Customized product | <input type="checkbox"/> Seat cushion as chosen, without cover | <input type="checkbox"/> For anatomical cushion as chosen on the left |
| N° 82.. | N° 81.. | N° 891003 | N° 998001 | N° 891004 |

| Back cushions (All covers with zippers and changeable) | | | |
|---|---|--|--|
| | Standard cushion | Anatomical back cushion | Cover design |
| <input type="checkbox"/> No back cushion (please tick if no cushion is required) | <input type="checkbox"/> Standard cushion for curved back plate , 3 cm thick, with zipper, breathable cover (see options on the right) | Anatomically formed, including cover, changeable, depr. depth: <input type="checkbox"/> 3 cm (...04) <input type="checkbox"/> 5 cm (...06) Only in association with back depression. | Breathable cover <input type="checkbox"/> black (20) <input type="checkbox"/> blue (21) <input type="checkbox"/> red (22) <input type="checkbox"/> grey (23) <input type="checkbox"/> green (24) <input type="checkbox"/> yellow (25) <input type="checkbox"/> orange (27) |
| | | N° 8911.. | N° 8517../8911.. |
| Additional covers for cushions as chosen on the right <input type="checkbox"/> 1 cover (...01) <input type="checkbox"/> 2 covers (...02) | | <input type="checkbox"/> Additional cover for anatomical back cushion as configured Customized product | <input type="checkbox"/> Back cushion as chosen, without cover |
| N° 85.. | N° 8517 | N° 891110 | N° 998501 |

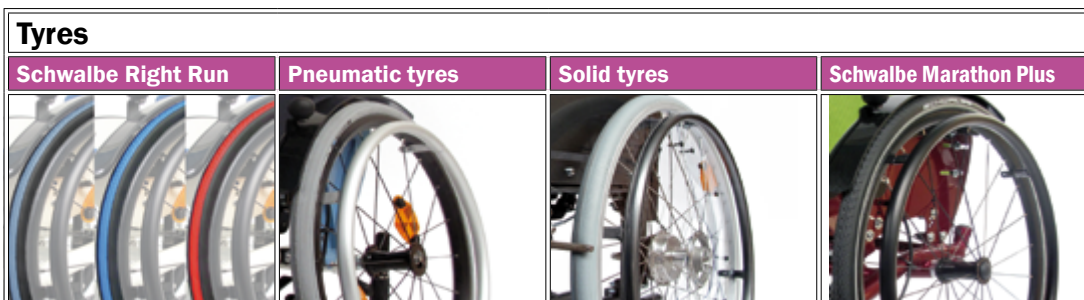
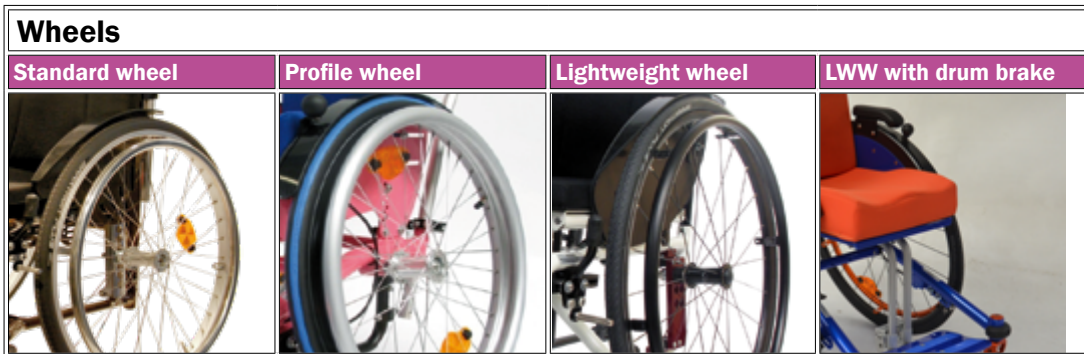
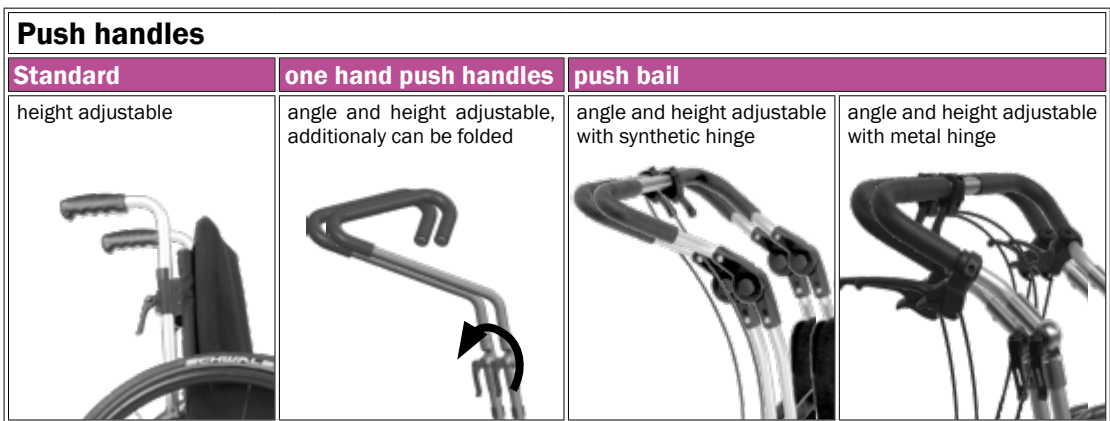
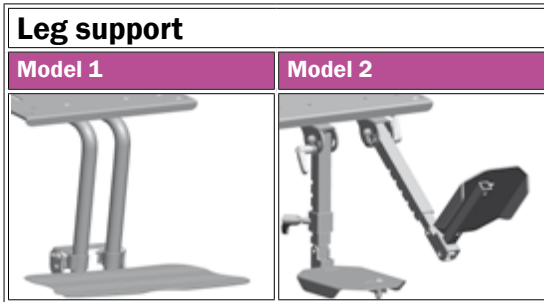

| | |
|---|---|
| Side guard | |
| Standard | |
| <input checked="" type="checkbox"/> | Component of synthetic and aluminium parts with wheel cover |
|  | |

| Leg support with foot rest (incl. calf belt, adjustable in height-, depth- and angle) | | | |
|---|---|---|--|
| Model 1 | Model 2 | Calf rest | Heel cups |
| <input type="checkbox"/> Foot rest undivided, hinged backwards, adjustable in distance, angle and height, | <input type="checkbox"/> Foot rest divided, adjustable in distance and height, steplessly hinged upwards up to 180° From SW 22 cm and LLL 23 cm, max. LLL 35 cm | for leg support 401905, Mounting calf rest <input type="checkbox"/> left <input type="checkbox"/> right <input type="checkbox"/> double-sided | Heel cups, self installation, black <input type="checkbox"/> Size 1 (..01) 7 x 11.5 cm <input type="checkbox"/> Size 2 (..02) 9 x 12.5 cm <input type="checkbox"/> Size 3 (..03) 10 x 15.5 cm |
| <input type="checkbox"/> Locking mechanism at 90° for foot plate Model 1 (N° 401901) | <input type="checkbox"/> Locking mechanism at 90° for foot plate Model 2 (N° 401905) | Possible from LLL 25 cm, foot plates are no longer hingeable backwards. From SW 26 cm | Heel edge <input type="checkbox"/> for foot plate/s |
| N° 4009 | N° 4009 | N° 403106 | N° 401904 |

| Push handles | | | |
|--|---|---|---|
| Standard | Single hand push handle | Push bow made of plastic or metal | |
| extendable, cranked: <input type="checkbox"/> 15 cm (..05) <input type="checkbox"/> 25 cm (..06) | <input type="checkbox"/> Foldable with steel joint, extendable by 20 cm only up to SW30 cm and nominal load max. 40kg | <input type="checkbox"/> extendable by 20 cm, adjustable in angle made of plastic up to SW 30cm at SW20/22 and BH25/30 only limited height adjustment possible | <input type="checkbox"/> extendable by 20 cm, adjustable in angle made of metal, from SW 32cm at BH25/30 only limited height adjustment possible |
| N° 65.. | N° 660202 | N° 6534 | N° 6532 |

| Brakes | |
|---|--|
| Bowden cable brake | Drum brake |
| <input type="checkbox"/> Bowden cable brake, integrated in activity side guards | <input type="checkbox"/> Drum brake for standard-, profile- or lightweight wheels (N° 21..30/31/82), incl. brake lever for the accompanying person If Bowden cable brake for the user is additionally required please tick also Article N° 3532. Only at a wheel camber of 11° (N° 201516) |
| | N° 220036 |

| Wheels | | | |
|---|---|---|--|
| Standard wheel | Profile wheel | Lightweight wheel | Lightweight wheel |
| <input type="checkbox"/> All-round wheel Additional weight of approx. 900g/wheel compared to lightweight wheels | <input type="checkbox"/> Unity of handrim and rim, reduces the risk of finger injuries Additional weight of approx. 800g/wheel compared to lightweight wheels | <input type="checkbox"/> with standard hub , very lightweight, incl. aluminium handrim Weight reduction of approx. 900g/Rad compared to standard wheel | <input type="checkbox"/> with drum brake hub , very lightweight, incl. aluminium handrim Weight reduction of up to 1,1 kg/wheel compared to standard drum brake wheels. |

| Tyres | | | |
|---|--|--|--|
| Standard | Standard | Design | Performance |
| Pneumatic: <input type="checkbox"/> Schwalbe <i>Right Run</i> 1" (grey/black) (..13) | Solid tyres: <input type="checkbox"/> Standard tyres 1" (grey) (..11) | Pneumatic: <input type="checkbox"/> Schwalbe <i>Right Run</i> 1" (blue/black) (..14) <input type="checkbox"/> Schwalbe <i>Right Run</i> 1" (red/black) (..15) Only for 24" wheels | Pneumatic: <input type="checkbox"/> Schwalbe <i>Marathon Plus</i> , black, pneumatic flat free tyres 1" Only for 22" and 24" wheels |
| | | N° 2024.. | N° 20..12 |

| Mounting hand rims (Please always state the desired mounting with standard wheels) | | | |
|---|---------------|------------|-----------|
| Standard tight | Standard wide | High tight | High wide |
| | | | |

| Handrim options | | | |
|------------------------|-------------------|------------------|-------------------|
| Silicone cover | Ergo rubber inlay | Maxgrepp handrim | Ergonomic handrim |
| | | | |

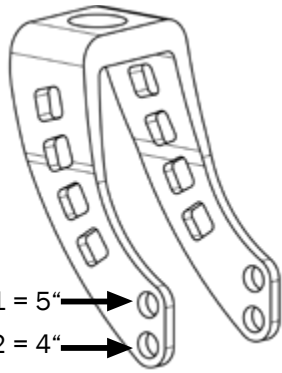

Seat heights
 All measures **WITHOUT** cushion!
 All measures ±5 %

| Wheel combination | Seat height measured without cushion from seat edge to floor with horizontal seat |
|--|--|
| Info: Mounting the wheels in the wrong borehole leads to a tilting of the wheelchair | |
| 20" x 4" (=B2) | 37,5 cm |
| 20" x 5" (=B1) | 37,5 cm |
| 22" x 4" (=B2) | 39,5 cm |
| 22" x 5" (=B1) | 39,5 cm |
| 24" x 4" (=B2) | 42 cm |
| 24" x 5" (=B1) | 42 cm |

| Caster wheels | | | | |
|----------------------|-----------------------|--------------------|-----------|---------------------|
| Standard PU | Standard solid rubber | Standard pneumatic | Design PU | Design solid rubber |
| | | | | |

| Caster forks | |
|---------------------|------------------|
| Standard Aluminium | Design Aluminium |
| | |

| Wheel size and wheel camber | | Handrims Mounting | | |
|---|--|--|---|---|
| Wheel size | Wheel camber | at standard wheel | at lightweight wheel | Ergonomic handrims |
| Size in inches <input type="checkbox"/> 20" recommended for SD 18-28 <input type="checkbox"/> 22" recommended for SD 22-32 <input type="checkbox"/> 24" recommended for SD 26-36 | Camber <input type="checkbox"/> 9° Mounting set wheel camber 7°/11°, preassembled on <input type="checkbox"/> 7° <input type="checkbox"/> 11° | Mounting <input type="checkbox"/> tight <input type="checkbox"/> wide <input type="checkbox"/> high <input type="checkbox"/> standard 20" only with mounting „high“ Material: <input type="checkbox"/> Stainless steel (30..01) <input type="checkbox"/> Aluminium (30..75) | Mounting <input type="checkbox"/> tight <input type="checkbox"/> wide <input type="checkbox"/> standard <input type="checkbox"/> high Material: Alu, silver anodized. combination standard/high not possible with lightweight wheel drum brake | <input type="checkbox"/> handrim with ergonomic handrim profile, black anodized with built-in rubber grip Only for 24" wheels |
| | N° 201516 | | | N° 342424 |

| Double handrim | | | |
|--|---|--|--|
| with standard hub | with drum brake hub | Opposite side | Distance |
| with standard hub and double handrim, only up to 9° camber Mounting <input type="checkbox"/> left <input type="checkbox"/> right | with drum brake hub and double handrim Mounting <input type="checkbox"/> left <input type="checkbox"/> right | <input type="checkbox"/> Handrim for the opposite side | Distance of double handrim <input type="checkbox"/> standard 18mm (...11) <input type="checkbox"/> tight 9mm (...12) <i>Distance tight: Not in combination with hand rim cover or coated hand rim</i> |
| N° 2614 | N° 2615 | N° 261435 | |

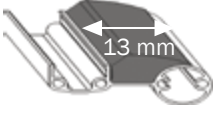
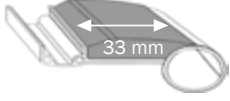
| Handrim options | | | |
|--|--|--|--|
| Silicone | PVC | Ergo rubber inlay | Maxgrepp handrims |
| Detachable silicone cover, black (soft surface) <input type="checkbox"/> for standard wheel(20-24) <input type="checkbox"/> for profile wheel (...02) <input type="checkbox"/> for lightweight wheel(...05) | <input type="checkbox"/> Handrim coated with black PVC, (<i>Tetra Grip</i>) Not for profile wheels | <input type="checkbox"/> Rubber inlay, 13mm wide Only for profile wheels | <input type="checkbox"/> Allows pushing with the palm of hand (soft surface) Only for standard wheels and lightweight wheels |
| N° 32.. | N° 33.. |  |  |
| for double handrims | for double handrims | | |
| Detachable silicone cover, black <input type="checkbox"/> for inside rim <input type="checkbox"/> for outside rim <input type="checkbox"/> for opposing side | <input type="checkbox"/> Handrim cover for double handrim, both handrims (inside and outside), coated with black PVC N° 262402 <input type="checkbox"/> Handrim cover for opposing side of the double handrim, coated with black PVC | | |
| N° 3205 | N° 262401 | N° 32..01 | N° 34.. |

| Spoke cover | Design Decors (Net prices are not discountable) | | | |
|--|--|--|--|---|
| Transparent | Please specify the desired model of the corresponding manufacturer: | | | |
| <input type="checkbox"/> transparent (...00) | <input type="checkbox"/> www.blueprince.de child's name on spoke cover | <input type="checkbox"/> www.speichen-schutz.de child's name on spoke cover | <input type="checkbox"/> www.wheelchairgadgets.com child's name on spoke cover | <input type="checkbox"/> Foil for curved back plate with the corresponding design as chosen Only with curved back plate |
| N° 25.. | N° 25..25 | N° 25..26 | N° 25..27 | N° 2527 |

| Caster wheels | | | |
|---|---|---|---|
| Standard PU | Standard solid rubber | Design PU | Design solid rubber |
| Polyurethane: <input type="checkbox"/> 4" (2812) <input type="checkbox"/> 5" (2805) | Solid rubber: <input type="checkbox"/> 4" (2804) <input type="checkbox"/> 5" (2809) | Polyurethane, transparent, with LEDs: <input type="checkbox"/> 4" (2820) <input type="checkbox"/> 5" (2834) | Solid rubber, black, with alu rim <input type="checkbox"/> 4" (2835) <input type="checkbox"/> 5" (2836) |

| Caster forks | | Steering options | |
|---|---|---|--|
| Standard Aluminium | Design Aluminium | Track fixation | Locking mechanism |
| <input type="checkbox"/> Alu fork, black anodized | <input type="checkbox"/> Alu fork, coated in frame colour | <input type="checkbox"/> track fixation (straight) (Not in combination with shock protection N° 9102) | <input type="checkbox"/> Locking mechanism for track fixation (Not in combination with shock protection N° 9102) |
| | N° 2829 | N° 2851 | N° 2850 |

| Options | Therapy tables | | Sun shade |
|--------------------------|--------------------|-------------------------|---|
| Outdoor Front End | Transparent | Design (example) | with flexible holder |
| | | | Removable sun shade. Easily adjustable in height and position by flexible holder. |

| Standard head rests <i>Measures in mm (all measures ± 10mm)</i> | | Lightweight head rest <i>Measures in mm (all measures ± 10mm)</i> | | | | | | | | | | | | | |
|---|----------------|---|--|--|--------|--------|--------|-----|-----|-------|-----|-----|-------|----|----|
| Model 1 | Model 2 | for weight reduction | | | | | | | | | | | | | |
| | | <p>Pad sizes:</p> <table border="1"> <thead> <tr> <th></th> <th>size 1</th> <th>size 2</th> </tr> </thead> <tbody> <tr> <td>height</td> <td>110</td> <td>130</td> </tr> <tr> <td>width</td> <td>200</td> <td>260</td> </tr> <tr> <td>depth</td> <td>30</td> <td>40</td> </tr> </tbody> </table> | | | size 1 | size 2 | height | 110 | 130 | width | 200 | 260 | depth | 30 | 40 |
| | size 1 | size 2 | | | | | | | | | | | | | |
| height | 110 | 130 | | | | | | | | | | | | | |
| width | 200 | 260 | | | | | | | | | | | | | |
| depth | 30 | 40 | | | | | | | | | | | | | |
| Model 3 | Model 4 | | | | | | | | | | | | | | |
| | | | | | | | | | | | | | | | |
| Model 5 | Model 6 | | | | | | | | | | | | | | |
| | | | | | | | | | | | | | | | |

| Belt systems | | | |
|---|---|----------------------------|--|
| 2-point pelvic belt with plastic fastener | 4-point pelvic belt with metal fastener | Chest-shoulder belt | Protection cap only for metal fastener |
| | | | |

| Lateral support (swing-away) | |
|---|--|
| <ol style="list-style-type: none"> 1. Connection to back 2. Button to swing away 3. Adjustable joint 4. Support for pads 5. Pads | |
| Measures for pads, size 1 16,5 x 4,5 cm 10 x 7 cm 10 x 9 cm | Measures for pads, size 2 15 x 10 cm 18 x 13 cm |

| Frame options | | | | Electric systems |
|---|--|--|--|--|
| Outdoor Front End | Splash guard | Bumper | Sun shade | For all electric aids we recommend casters of 5" or higher. Please regard the possible mounting specifications of the manufacturer. AAT Systeme www.aat-online.de Alber Systeme www.alber.de |
| <input type="checkbox"/> facilitates significantly active and passive driving on soft or rough surfaces, incl. jack up aid. | <input type="checkbox"/> Splash guard for Outdoor Front End, made of black plastic | <input type="checkbox"/> Bumper, made of rubber to protect furniture, doors, etc. Frame form „Taurus“ not possible with Restraint system. | <input type="checkbox"/> Variable adjustable sun shade in black with measurements 36x36 cm (LxH) Can be mounted up to a seat width of 38 cm. | |
| N° 599516 | N° 59951212 | N° 9102 | N° 910300 | |

| Therapy tables | |
|--|--|
| Transparent | Design |
| Central installation, plugged under seat plate, adjustable in height and distance <input type="checkbox"/> Size 0 (...10) (39 cm width, recommended for SW 18-24) <input type="checkbox"/> Size 1 (...11) (46 cm width, recommended for SW 26-30) <input type="checkbox"/> Size 2 (...12) (59 cm width, recommended for SW 32-36) Restrictions in combination of therapy table and abduction wedge: Height adjustment of therapy table is limited and therapy table can only be used in combination with abduction wedge holders | <input type="checkbox"/> Number of design for plexi-glas therapy table according to www.wheelchairgadgets.com |
| N° 9209.. | N° 920099 |

| Positioning aids Here you will find a small selection to mark. You will find more positioning aids, corresponding mounting possibilities and further equipment in the separate order form „Positioning aids“ | | | | |
|---|--|--|--|---|
| Order form „positioning aids“, available in download area. More products for positioning, e.g.: <ul style="list-style-type: none"> • belts, • fixations and corresponding connections, • abduction wedges, • side truss pads, • head rests and more... On the order form refer to this new wheelchair order/enquiry | 2-point pelvic belt | 4-point pelvic belt | Standard head rests | Lightweight head rest |
| | <input type="checkbox"/> with plastic fastener <input type="checkbox"/> with metal fastener The size is determined by us according to the chosen wheelchair measurements. | <input type="checkbox"/> with plastic fastener <input type="checkbox"/> with metal fastener The size is determined by us according to the chosen wheelchair measurements. | <input type="checkbox"/> Model 1, (...21) shell-shaped small <input type="checkbox"/> Model 2, (...22) shell-shaped large <input type="checkbox"/> Model 3, (...23) curved small <input type="checkbox"/> Model 4, (...24) curved large <input type="checkbox"/> Model 5, (...25) x-shaped small <input type="checkbox"/> Model 6, (...26) x-shaped large | Lightweight head rest, adjustable with two conical joints, connection and removable cover included. (cover with same Betex-color as back cushion) <input type="checkbox"/> Size 1 (...20) Pad size 110x200mm <input type="checkbox"/> Size 2 (...21) Pad size 130x260mm Weight reduction approximately 800-1000g to standard head rest systems. |
| | N° 780502 | N° 780504 | | |
| | Chest-shoulder belt | Protection cap | | |
| | <input type="checkbox"/> Chest-shoulder belt without zipper | <input type="checkbox"/> protection cap for metal fastener Makes independent opening for the patient difficult. | | |
| N° 7810 | N° 78050210 | N° 6860.. | N° 686009.. | |

| Transport brackets |
|---|
| <input type="checkbox"/> Transport brackets (4 pieces) for transportation in a handicapped accessible passenger car |
| N° 58507710 |

| Lateral support | | | |
|---|--|---|--|
| Holder | Pad | | Extensions |
| Holder adjustable, size 1, incl. linkage, without pad <input type="checkbox"/> left side (...01) <input type="checkbox"/> right side (...02) | for truss pad size 1 Attention: Cushions for size 1 can only be mounted on truss pads size 1. 1 pcs. 2 pcs. <input type="checkbox"/> <input type="checkbox"/> 10x7cm (...04) <input type="checkbox"/> <input type="checkbox"/> 10x9 cm (...05) | for truss pad size 2 Attention: Cushions for size 2 can only be mounted on truss pads size 2. 1 pcs. 2 pcs. <input type="checkbox"/> <input type="checkbox"/> 15 x 10 cm (...04) <input type="checkbox"/> <input type="checkbox"/> 18 x 13 cm (...05) | Additional extension of joint for size 1 (3,8 cm) (...0103) 1 St. 2 St. <input type="checkbox"/> <input type="checkbox"/> for size 2 (5,5 cm) (...0203) 1 pos. 2 pos. <input type="checkbox"/> <input type="checkbox"/> |
| N° 685901.. | | | |
| Holder adjustable, size 2, incl. linkage, without pad <input type="checkbox"/> left side (...01) <input type="checkbox"/> right side (...02) | | | |
| N° 685902.. | N° 685901.. | N° 685902.. | N° 6859.. |



Abbreviations

pieces - pcs
pair - P
net price - NP
additional charge - AC
lower leg length - LLL

seat width - SW
seat depth - SD
back height - BH
customized product
discount - CPD

Terms and conditions

1. Preface and Scope

(1) Our terms and conditions apply exclusively. Any deviating, opposing, or complementing terms and conditions on the part of the business partner do not form integral part of contract unless explicitly approved of by us. There are no exceptions to the consent requirement, which also applies in cases where we conduct deliveries without restrictions while aware of the business partner's terms and conditions.

(2) Agreements made in the individual case with the purchaser (including side-agreements, supplements, and alterations) always take priority over these terms and conditions. A contract or our confirmation - both in written form - are authoritative for the content of such arrangements.

(3) Any legally relevant declarations and notifications the purchaser submits to us after conclusion of the contract (e.g. setting of deadlines, notice of defects, declarations of rescission or abatement) require the written form to be valid.

(4) Any information on the application of legal regulations serves the mere purpose of clarification. All regulations are legally binding without any such clarifications unless explicitly altered or excluded in these terms and conditions.

2. Prices

All prices are ex works, excluding insurance and packaging. The prices are net prices; the value-added tax is stated and charged separately according to the legally binding rate at the time of invoicing. The prices valid on the day of delivery are binding unless explicitly arranged otherwise.

3. Conclusion of Contract

SORG's offers are invitatio ad offerendum (invitations to treat). Ordering goods counts as an obligatory offer of contract on the part of the purchaser. Unless the order suggests otherwise, we have the right to accept this contract offer within two weeks time after reception. The acceptance of an offer of contract is effected by the confirmation of the order.

4. Terms of Payment

(1) Provided that no other agreements exist, payment is to be made by paying in advance - 50% at placing of order, 50% pre-delivery of goods. The purchaser bears any costs arising from transactions or discounting.

(2) If a 30-day payment deadline is exceeded, a delay rate of 8% on top of the respective base rate of the European Central Bank falls due without the need for prior notices. Beyond that, the purchaser is charged 3.- € for any reminder sent. We reserve the right to make use of the commercial due rate according to § 353 HGB. A higher damage for delay may be enforced via a suitable verification.

5. Offers and Validity

All current price lists are generally valid until March 31 of the respective year, or until new price lists are published. The latest version of the price list will always be provided on our homepage. Offers older than 3 months at that point expire and must be replaced with new offers and prices.

6. Time of Delivery and Delay

We state the terms of delivery when accepting the order. The delivery date is non-binding and has mere guideline value - especially with regard to customised products. The terms for delay in delivery are defined by legal regulations. In any case, a writing notice issued by the purchaser is necessary for them to take effect.

7. Force Majeure (Act of God)

(1) SORG is not to be held responsible for the following delays of delivery. This also applies if these causes occur with respect to legal representatives, auxiliary persons, or deliverers of SORG: Circumstances of force majeure as well as other extraordinary events that are unpredictable and unavoidable for, and not caused by, SORG, and that only occur after ordering or reserving, and that SORG could not have known about. Moreover, this applies in case of strikes, fire, floods, labour disputes, business disruptions, altered magisterial approbation and legal situation, and magisterial orders which are not due to operational risks.

(2) In the cases of paragraph 1, SORG is eligible to delay delivery/performance for the time of hindrance as well as an appropriate start-up time. If SORG thus causes unacceptable complications for the purchaser, both SORG and the purchaser are eligible to withdraw from the contract. Circumstances that only lead to a temporal and hence acceptable delay of delivery and performance are excluded from this right. The legal rights of the client remain unaffected.

8. Dispatch

We generally dispatch uncovered by insurance and at the recipient's risk. We transfer the risk of coincidental loss or deterioration of the goods as well as delay on to the client at the moment of passing the goods on to the forwarder, bearer, or any other person/institute responsible for delivery. SORG will make any effort to respect the client's wishes in terms of path and kind of delivery. Any costs caused by this (including agreed carriage free delivery) are to be covered by the client. In the case of carriage free delivery conducted by SORG, the recipient is required to put forward any carriage costs for a refund. If the client wishes the dispatch to be delayed, any risk of loss or deterioration of the goods is carried by the recipient from the first day of readiness for dispatch. The goods dispatched are only insured upon special demand and at the cost of the recipient.

9. Damage through Delivery/Angelieferte Gegenstände sind, auch wenn sie unwesentliche Mängel
Upon delivery, the goods need to be checked for obvious damage in the presence of the bearer. Any damage is to be documented in a written form and co-signed by the bearer. This protocol is to be forwarded to us immediately. Delayed reclamations, or reclamations not signed by the bearer, cannot be taken into account.

10. Warranted Features, Receipt, and Technical Alterations

Delivered objects, even with minor damage, are to be accepted by the client, even if §433, paragraph 1 BGB is not fulfilled. Partial deliveries are permissible. Features only count as warranted if explicitly designated as such. A warranty of condition can only be asserted explicitly and in a written form. SORG reserves the right for technical alterations, especially for solutions of equal or higher value.

11. Warranty for Defects

(1) SORG warrants for any defects of delivered new goods for 12 months as long as the purchaser is not the user (§§ 474, 13 BGB). Should the purchaser be the user then the warranty period is two years for new goods, for used goods 12 months. Should the purchaser also be an entrepreneur, then the liability for used items is void, as long as there is no claim for compensation according to N° 12.

(2) The purchaser's claim for defects presuppose that he has attended his obligation to give notice of defects on the legal grounds for his reasons of inquiry (§§ 377, 381 HGB). If defects are found during the inspection or at a later point, we are to be notified in writing without delay. The notice counts as not delayed if issued within two weeks. Posting the notice on time suffices for the keeping of the term. Independently from this obligation to inspect and give notice, the purchaser

is to report obvious defects (including wrong and short delivery) within two weeks upon delivery (again, posting the notice on time suffices). If the purchaser misses the proper inspection and/or notice of defects, we do not warrant for the reported defects. If the delivered good is defected, we may choose to conduct supplementary performance either by repairing the defect (subsequent improvement) or by delivering flawless goods (compensation delivery). Our right to refuse the chosen method of supplementary performance on the respective legal grounds remains untouched.

(3) Our liability for defects expires when alteration or maintenance works are done by the client or a third-person-party without our prior written permission. Consequences of excessive strain, negligent or incorrect handling, and violent damage are excluded from the warranty for defects.

12. Further Liability

(1) With respect to compensation - regardless of the legal cause - SORG is only liable in case of malice and act of gross negligence. In case of slight negligence, SORG is only liable for damage of life, body, health, and for damage caused by the negligence of an essential contractual obligation (an obligation whose fulfillment make the proper realisation of the contract possible in the first place and in whose fulfillment the contract partner regularly trusts and can trust). In this case, however, our liability does not exceed the covering of predictable, typically occurring damage.

(2) A free right to termination on the part of the purchaser (acc. to § 651, 649 BGB in particular) is precluded. Otherwise, the usual prerequisites and legal consequences apply.

13. Costs of Supplementary Performance

Costs of supplementary performance cannot be charged on SORG's account.

14. Voluntary Withdrawal of Goods

SORG is not obliged to take back any delivered end products or parts thereof. If SORG voluntarily decides otherwise in individual cases (especially for therapeutically altered requirements or deaths), SORG refunds a maximum of 75% of the delivery costs for unused parts whose delivery does not date back more than three months. There is no legal obligation concerning withdrawal in this respect. Deliveries which date back more than three months as well as sewed parts and customised products are not returnable. A copy of the delivery note or the bill serves as proof of age of delivery.

15. Reservation of Ownership

Goods delivered by SORG remain the property of SORG until any obligations from the parties' business contract on the part of the purchaser have been redeemed. This also applies if SORG has adapted individual or all claims into a running account which has been balanced and acknowledged. The purchaser has the right to dispose of the goods in the proper course of business. The purchaser hereby yields all claims to SORG which arise from the resale against the purchaser or third parties. The purchaser is authorised to withdraw these claims even upon conveyance. SORG's right to withdraw the claims remains untouched. However, SORG is obliged not to withdraw the claims as long as the purchaser complies with his duty of payment and any other duties. SORG has the right to demand that the purchaser makes known the yielded claims and their debtors, that he provides all information necessary for conveyance, and that he hands in all associated documents. As long and insofar the reservation of ownership is intact, the purchaser must not transfer any goods for securing or bailment without SORG's permission. The purchaser may process or alter the goods for the benefit of SORG exclusively. If processed with other goods which do not belong to SORG, SORG obtains co-ownership of these new goods in relation to the invoice value to the cost price of the other processed goods. If a third party interferes with SORG's ownership, the purchaser is to notify SORG immediately. The purchaser must not make any agreements with other purchasers which may exclude or limit SORG's rights. In particular, the purchaser must not make any agreements which destroy or limit the advance assignments to SORG. If the estimated value of the existing guarantees exceeds the claims to be ensured by more than 20%, SORG is insofar obliged to release by request of the purchaser.

16. Copyright Protection

If SORG conveys any images, drawings, indications of weight or measurements, technical documentations, or other product descriptions and documents (including electronic ones), the respective indications only apply if explicitly stated that they do. SORG reserves ownership and copyright of all these documents. They may only be made available to third parties upon SORG's explicit permission.

17. Place of Fulfilment, Place of Jurisdiction, and Severability Clause

(1) The law of the Federal Republic of Germany applies for these Terms and Conditions and all legal relations between us and our business partners. All international and supranational (contractual) legal systems, the UN Convention on Contracts for the International Sale of Goods in particular, are hereby excluded. Prerequisites and effects of the reservation of ownership acc. to no. 15 are subject to the right of the respective storage location of the good if the choice of law made in favour of the German law is illegitimate or ineffective. The only place of jurisdiction (also on an international basis) for any disputes arising directly or indirectly from the contractual relationship is, according to German Commercial Code, our office in Oberhausen-Rheinhausen, Germany. However, we also have the right to file a suit concerning the general jurisdiction of the purchaser.

(2) If any clause in these Terms of Conditions should turn out to be ineffective, this does not affect the effectiveness of all other clauses.

Technical alterations and misprints reserved. As of: January 2017

SORG Rollstuhltechnik GmbH + Co. KG
Benzstr. 3-5, 68794 Oberhausen-Rheinhausen / Germany
Phone +49 7254 / 9279-0
Fax +49 7254 / 9279-10
info@sorgrollstuhltechnik.de, www.sorgrollstuhltechnik.de